

RICOH Smart Device Print User Manual

for Android

Ver1.0
Ricoh Company, Ltd.

(1) Introduction

This manual describes how to correctly use the Smart Device Print application on Android and the precautions of its use.

Please read this manual carefully before using the application.

- **Application Overview**

This application is one that can print photos or documents on Android devices using Ricoh printers or MFP.

- **Supported Android devices**

Please refer to the Support Page.

- **Supported Android OS versions**

2.2 or above

- **Printer or MFP to print with**

Ricoh printers or MFP

For more information on supported models (models on which this application has been tested OK), please refer to the support page.

- **LF (location free) print server to print with**

Enhanced Locked Print NX FlexRelease Server V2

- **On-demand print application to print with**

Enhanced Locked Print NX V2

(2) How to read this manual

2-1. Annotations used in this manual

Important: indicates things you should pay attention to when using the functions of the application.

Be sure to read carefully, as failure to do so may lead to unexpected consequences such as misprint or loss of data.

Note: indicates additional information to the functions, as well as measures to be taken in case of improper operation.

Buttons or items on the operation screens in this application are indicated by [].

Operations and settings other than those in the application, such as settings on Android OS or Android device, are indicated by <> .

2-2. Notes on this manual

This manual is created based on Nexus 7 with Android OS version 4.1.2 or above.

The contents in this manual are subject to change without notice.

Please understand that some of the illustrations or descriptions in this manual may vary due to changes for improvement in this application, Android OS or Android devices.

This manual shall not be copied, duplicated, changed, quoted or reproduced in part or in full without permission.

(3) What can you do with this application

- Print photos in Android devices.
- Print documents (PDF) in Android devices.
- Print texts saved on the clipboard.
- Print the web pages displayed in this application.
- Print photos or documents opened in this application by using < application selection > in other applications.
- Print securely using user code or user authentication.
- Print using on-demand print application.
- Print using LF (location free) print server.

(4) When using this application

4-1. Connecting Android device to Wi-Fi

On Android device, select <Settings> , <Wireless & Networks> and <Wi-Fi> , then select and set Wi-Fi network according to your environment and make Wi-Fi connection.

Note: For more information on network settings, please contact your network administrator.

4-2. Connecting to printer or MFP

Please check the user manual of the printer or MFP you are going to use, or consult your network administrator.

(5) Screens in this application

5-1. Menu Screen

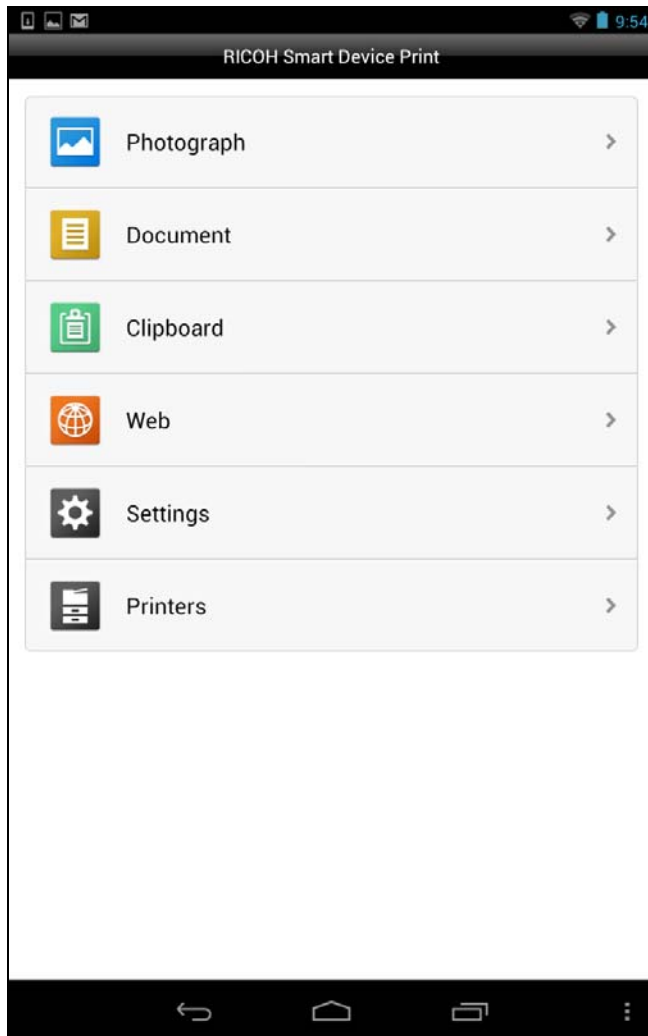

You can select items to print or to set.

5-2. Print Preview Screen

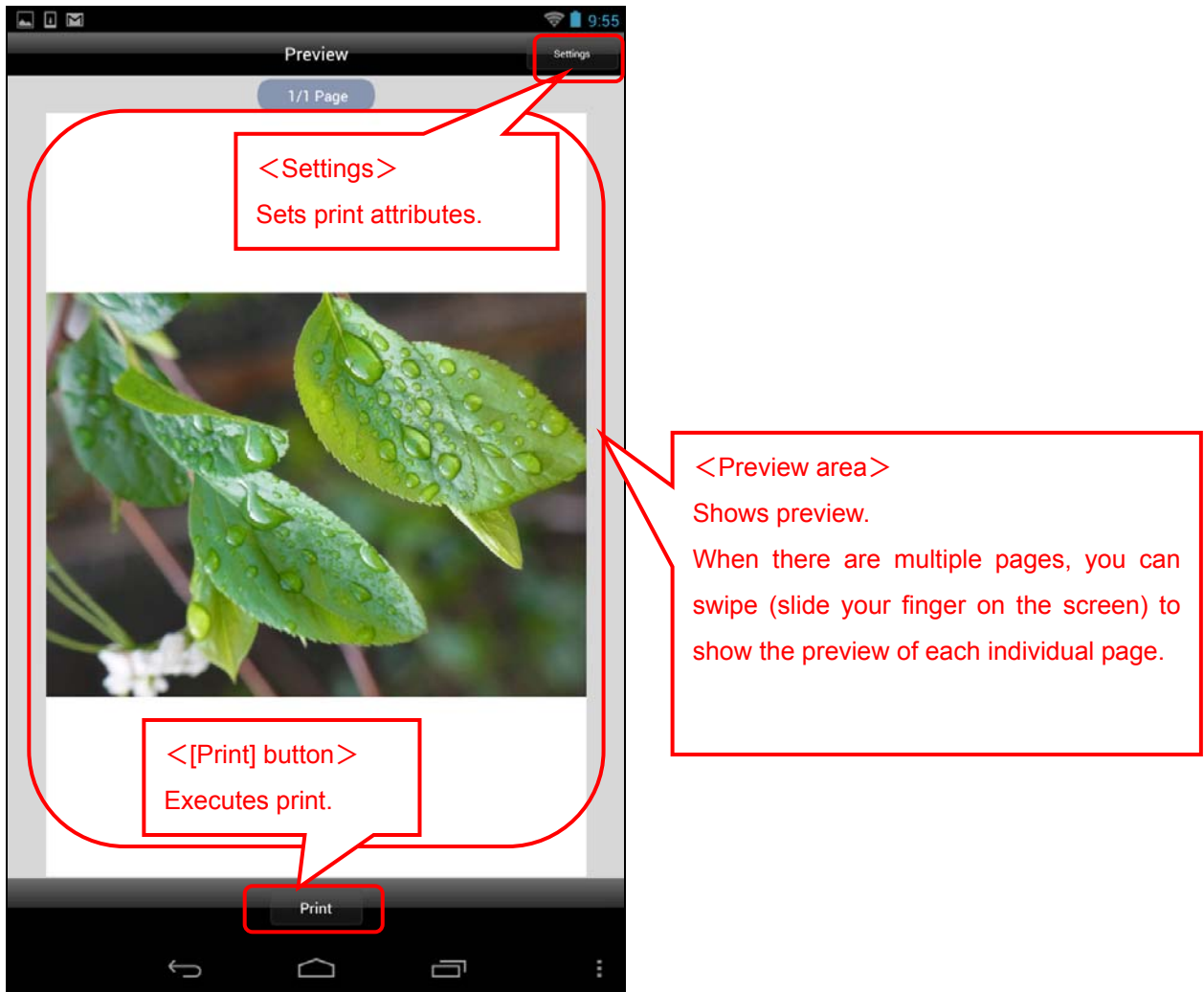

- Preview area
Shows preview. When there are multiple pages, you can swipe (slide your finger on the screen) to show the preview of each individual page.
- [Setting] button
Used to change print attributes
- [Print] button
Executes print

(6) Specifying the printer, MFP or LF (location free) print server to print with

Search Printer

Search on Bonjour

Host Name or IP Address Search

☒ Search for Server

Share Name :

Share Name

<[Search on Bonjour] button>
Executes search on Bonjour

Search printer by inputting DNS host name or IP address.
To search for LF server, check the "Search Server" checkbox, and also input the share name.

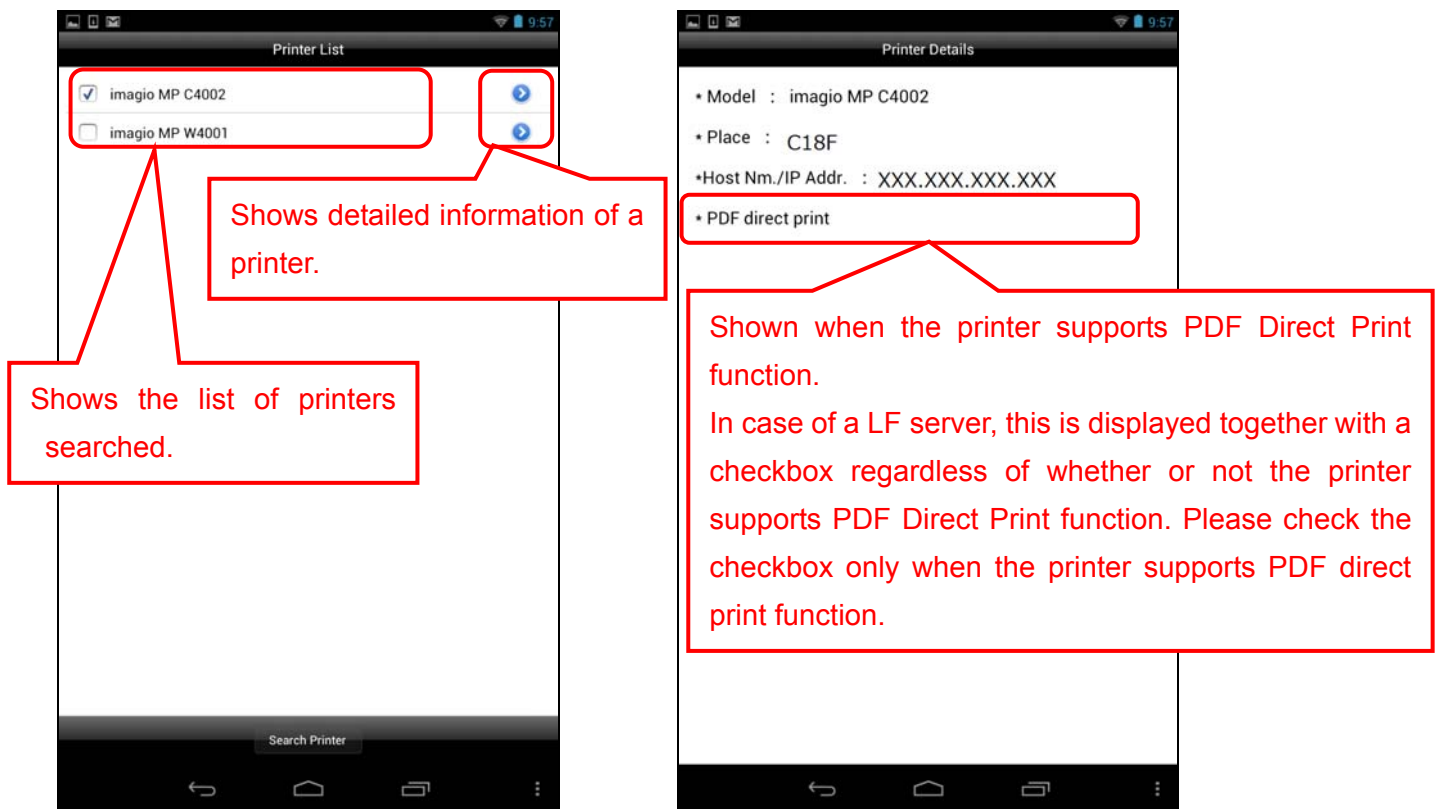

6-1. Searching and specifying the printer or MFP to print with on Bonjour

1. Select [Printers] on the menu screen, and press [Search printer] button.
2. Press [Search on Bonjour] button.
3. When search results are displayed, select one or more printers you want to add.
4. Press [Printers] button to add the printer(s) to [Printer list].
5. Select a printer or MFP to print with from the printers displayed in [Printer list].

Note: Printers or MFPs on which this application has not been tested are also shown in the search results.

Please confirm whether the model is one on which this application is supported.

Note: The printer or MFP to search must be in the same subnet as the Android device.

6-2. Specifying printer or MFP by manually inputting DNS host name or IP address

1. Select [Printers] on the menu screen, and press [Search printer] button.
2. Press the Host Name / IP Address input field.
3. Input host name or IP address using the keyboard displayed.
4. Press [Search] button.

5. When search results are displayed, select printer(s) to add.
6. Press [Printers] button to add the printer(s) to [Printer list].
7. Select the printer or MFP to print with from the printers displayed in [Printer list].

Note: Please input an IP address that consists of four numbers ranging from 0 to 255 separated by periods (for example, 168.190.0.1).

Note: The printer or MFP must support SNMP.

Note: Printers or MFPs on which this application has not been tested may also be specified. Please confirm whether the model is one on which this application is supported.

Note: For host name, please input the host name registered in DNS server.

6-3. Specifying LF server by manually inputting DNS host name or IP address

1. Select [Printers] on the menu screen, and press [Search printer] button.
2. Check the [Search Server] checkbox.
3. Tap the Host Name / IP Address input field.
4. Input the host name or IP address with the keyboard displayed.
5. Tap the Share Name input field.
6. Input the share name with the keyboard displayed.
7. Press the [Search] button.
8. When the search results are displayed, select the printer to add.
9. Press the [Apply] button to add to [Printer list].
10. Select a LF server from the printers displayed in the [Printer list].

Note: Please input an IP address that consists of four numbers ranging from 0 to 255 separated by periods (for example, 168.190.0.1).

Note: Please refer to “LF (location free) print server to print with” in “(1) Introduction” for supported LF server.

Note: Please input the share name set to LF server for Share Name. Please contact your network administrator for details.

Note: Share name in double-byte characters can not be set in this application.

Note: For host name, please input the host name registered in DNS server.

Important: When a LF server is specified, [PDF direct print] is always displayed. Please check the [PDF direct print] checkbox only when the LF server you are using supports PDF direct print function.

Important: If the information (such as IP address) of a printer or MFP registered in the printer list is changed, please delete the printer or MFP from the printer list, and then add it to the list again. Otherwise, unexpected problem may occur as the printer tries to print with the information before the change.

(7) Setting print attributes

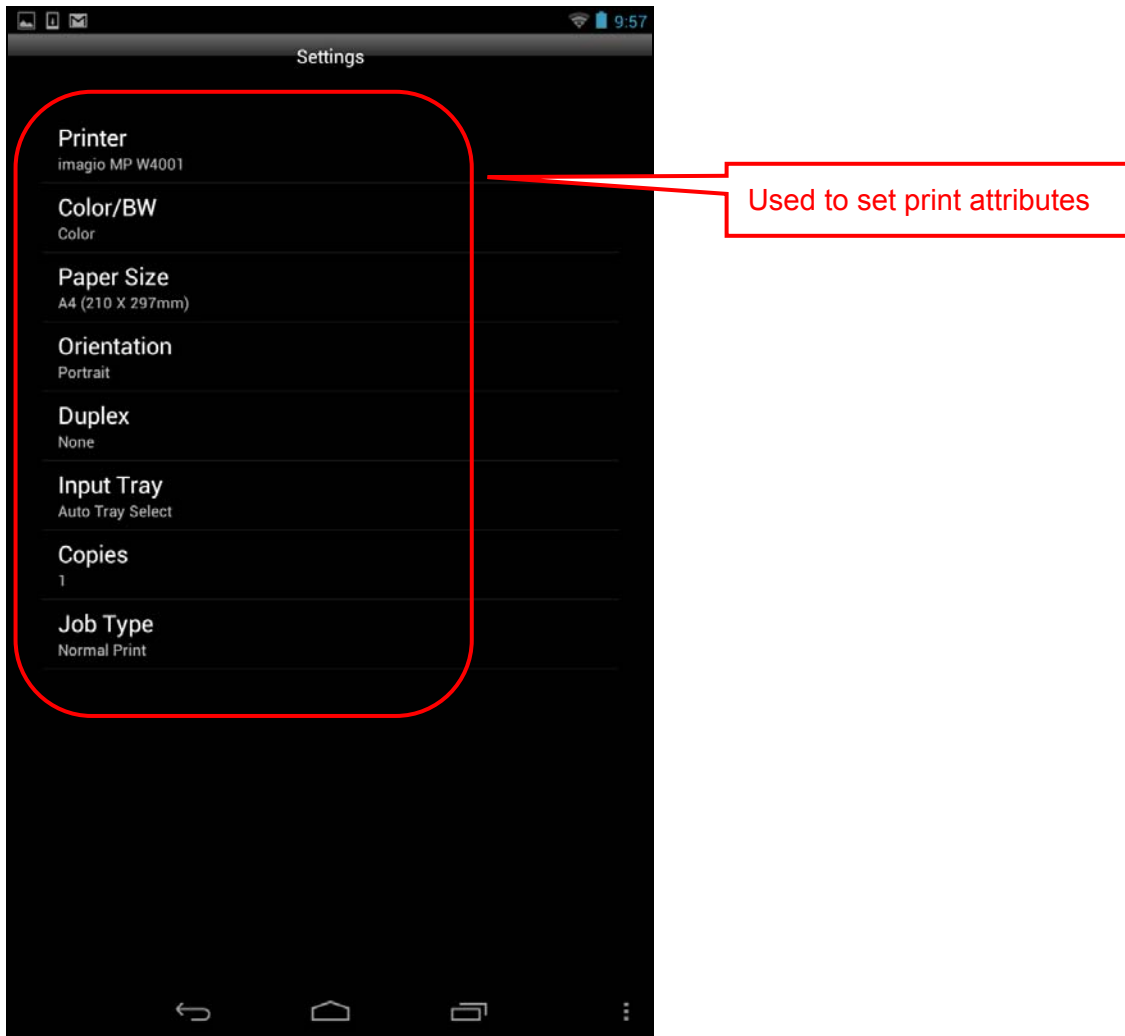

There are two screens for setting print attributes.

7-1. Setting printer attributes

1. Select what you want to print from [Photograph]/ [Document] /[Clipboard] /[Web] menu screen, and then select settings.
2. Set print attributes as necessary.

7-2. Setting initial values for the print attributes displayed in print preview screen

Changes to the settings will not be reflected until the next time the application starts.

Neither will the changes be reflected when you go back to the Home screen or switch to another application. To reflect the changes, please press the return key on the Home screen (menu screen) of the application to exit the application, and then restart it.

1. Select [Setting] menu.
2. Set print attributes as necessary.

Available print attributes are as follows:

[Printers]

Select a printer to print with from the registered printers.

- Available printers
Printers registered in the printer list

Initial setting: printer set as initial setting on the Printer List screen.

Note: please register a printer if none has been registered.

[Color/BW]

Select whether to print in color or in BW.

- Color
- Black and white

Initial setting: Color

Important: When a black and white original is printed with the Color setting, it may be printed with cyan, magenta, yellow and black toner. Therefore, it may be counted in the color counter in the printer. If you only want to use black toner to print, please set to BW. If color original is mixed with BW original, when they are printed with the Color setting, BW original may also be counted in the color counter.

[Paper size]

Sets paper size.

- Available paper sizes

A3, B4, A4, B5, A5, 11×17, 8 1/2 × 14, 8 1/2 × 11, 5 1/2 × 8 1/2

Initial setting: A4

[Paper type]

Sets paper type.

- Available paper types
Plain & Recycled, Coated paper

Initial setting: Plain & Recycled

[Orientation]

Sets paper print orientation.

- Portrait
- Landscape

Initial setting: Portrait

[None/Duplex]

Select to print on one side or two sides.

- None
- Open to left
- Open to top

Initial setting: None

[Page layout]

Select whether or not to print 2 pages into 1 page.

- 2 in 1
- None

Initial setting: None

[Input tray]

Select the paper tray to print from.

- Available paper trays
- Auto tray select, tray 1, tray 2, bypass tray

Initial setting: Auto tray select

[Job type]

Select how to print.

- Normal print
- Locked print

Initial setting: Normal print

Note: When Locked print is selected, please set user ID and locked print password.

[Font size]

Set the font size to print the copied text in clipboard.

- Small (10 points)
- Medium (12 points)
- Big (14 points)

Initial setting: Medium (12 points)

[Pages]

Specify print pages.

- from 1 to 99

Initial value: from 1 to 1

[Copies]

Specify the number of copies.

- 1 ~99

Initial setting: 1

[User ID]

Set for locked print or when on-demand print application is used for printing.

- up to 8 alphanumeric [a-z,A-Z,0-9] characters

Initial setting: blank

<Locked Print Details>

[Password]

Set the password for locked print.

- 4-8 digit numbers

Initial setting: blank

<Authentication settings>

Set user authentication and user code authentication.

When user authentication setting is on, login user name and login password can be inputted.

When user authentication setting is off, user code can be inputted.

Note: If the driver encryption key set to the printer is changed from its initial setting, user authentication from this application will fail.

Please contact your administrator for the setting of the driver encryption key.

[User authentication]

Select whether to print with user authentication information or not.

- On
- Off

Initial setting: off

[Login user name]

Set the login user name for user authentication.

- alphanumeric characters/symbols

Initial setting: blank

[Login password]

Set the login password for user authentication.

- alphanumeric characters/symbols

Initial setting: blank

[User code]

Set the user code for user authentication.

- up to 8-digit numbers

Initial setting: blank

The print attributes that can be set on Setting screen are as follows: (You can access Setting screen directly from Menu, or from Setting button on Print preview screen of Photograph, Document, Clipboard or Web.)

○ : Can be set - : Can not be set

		Setting screen				
		Menu	Photograph	Document	Clipboard	Web
Print attributes	Printer	–	○	○	○	○
	Color/BW	○	○	○	○	○
	Paper size	○	○	○	○	○
	Paper type	○	○* 1	○* 1	○* 1	○* 1
	Orientation	○	○	–	○	○
	None/Duplex	○	○	○	○	○
	Page layout	–	–	○	–	○
	Input tray	○	○	○	○	○
	Job type	○	○	○	○	○
	Print quality	–	–	–	○	–
	Font size	–	–	○	–	–
	Pages	○	○	○* 2	○	○* 2
	Copies	○	–	–	–	–
	User ID	○	–	–	–	–
	<Locked print details> • Password	○	–	–	–	–

* 1 : Can be set only when you are printing with a GELJET printer.

* 2 : When more than 2 copies are set, they are always printed in a collated manner.

However, on printers or MFPs that do not support Collate function, they are printed in a stacked manner.

(8)Printing photos

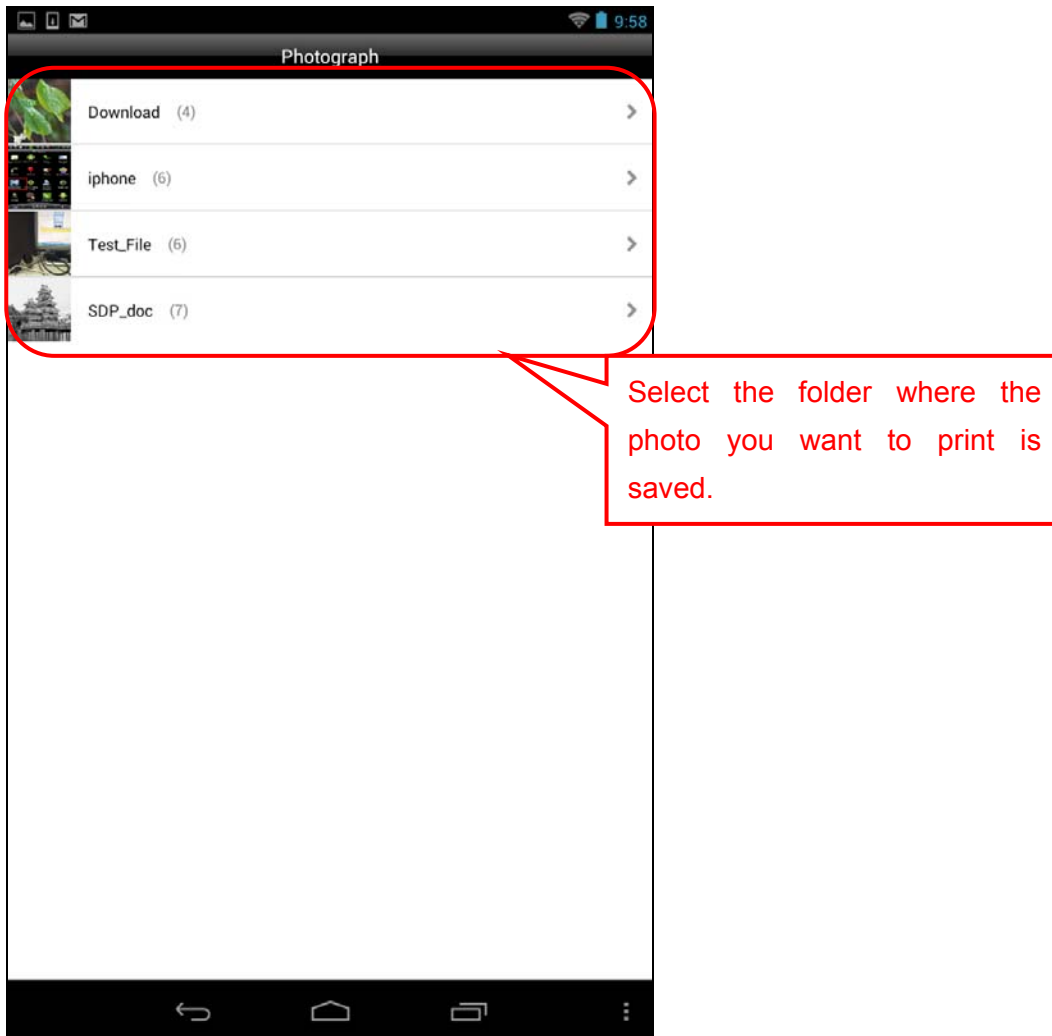

Print the photos in Android device.

Supported image format is JPG.

1. Select [Photograph] menu.
2. Select the list with the photo(s) you want to print.
3. Select one or more photos to print from the list.
4. Press [Print preview], and the preview will be displayed.
5. Set print attributes as necessary.
6. Press [Print] button.

Note: For more information on each print attribute, please refer to "(7) Setting print attributes".

Note: If you do not want to print a photo already selected, press the photo to remove the check mark. If you want to print the photo again, press it so that a check mark appears on its upper right corner.

Note: After you have selected a photo and switched from [Photograph] menu to another menu, when you switch back to [Photograph] menu, a message will be displayed asking whether you are sure to cancel the selection of photograph. Press [OK] to cancel the selection, or press [Cancel] to continue selecting photos in the [Photograph] menu or to print.

(9) Printing document

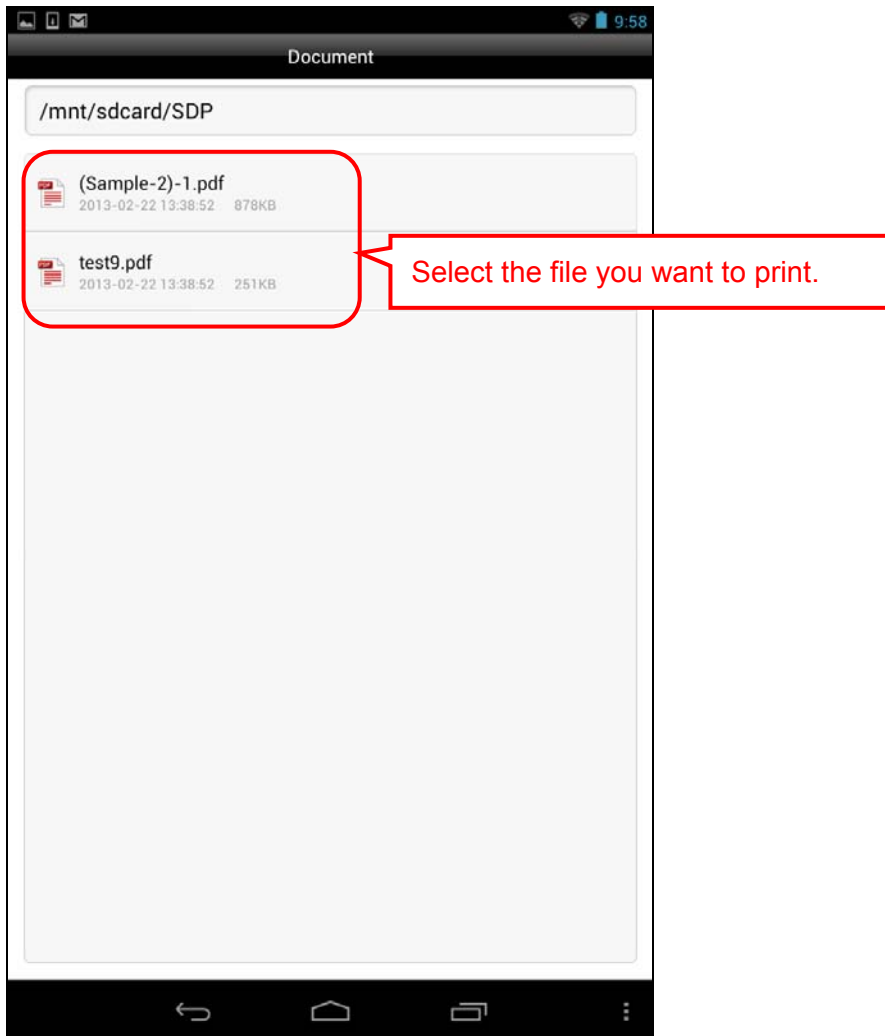

Print the documents (PDF) on Android device.

1. Select [Document] menu.
2. Select the folder where the document you want to print is saved.
3. Select the document.
4. If you want to confirm the contents of the document, press [Open by other app] button and select an application.
5. Set print attributes as necessary.
6. Press [Print] button.

Note: If no application is available when you press [Open by other app] button, please install an application such as <Adobe Reader> that can display PDF.

Note: For more information on each print attribute, please refer to "(7). Setting print

attributes”.

Note: In order to print a PDF document, the printer or MFP you are going to use must support PDF Direct Print function.

If a printer or MFP supports PDF Direct Print function, “PDF Direct Print” item will be displayed on [Printer details] screen.

Note: Due to additional PDF functions such as encrypted PDF, documents may not be correctly printed.

If the number of print pages cannot be read correctly, "from 1 to blank" may be shown under Pages. If you want to print all the pages, there will be no problem; However, if you want to specify a page to print, please press "Another app." button and select an application, then specify a page in the correct range after having confirmed the number of pages in the PDF file.

If a wrong print range is specified, it may not be printed.

Note: For more information on the PDF versions supported by PDF Direct Print function, please check the user manual of the printer or MFP you are using, or consult your network administrator.

Important: When Print button is pressed, if a dialog is displayed indicating there may be problem with duplex setting, press Cancel button and do the following.

1. Press "Another app." and select an application, then confirm the orientation of the first page of the PDF file.
2. If the orientation is portrait, there will be no problem.

Please press Print button again to print.

If the orientation is landscape, the print result will be opposite to the settings of Open to Left and Open to Top.

Please print by reversing the opening direction.

(10) Printing clipboard contents

Print the contents copied onto the clipboard.

1. Select [Clipboard] menu.
2. Set print attributes as necessary.
3. Press [Print] button.

Note: For more information on each print attribute, please refer to "(7) Setting print attributes".

Note: For information on how to copy text to the clipboard, please refer to the user manual of the Android OS or the application you want to copy from.

(11) Printing Web pages

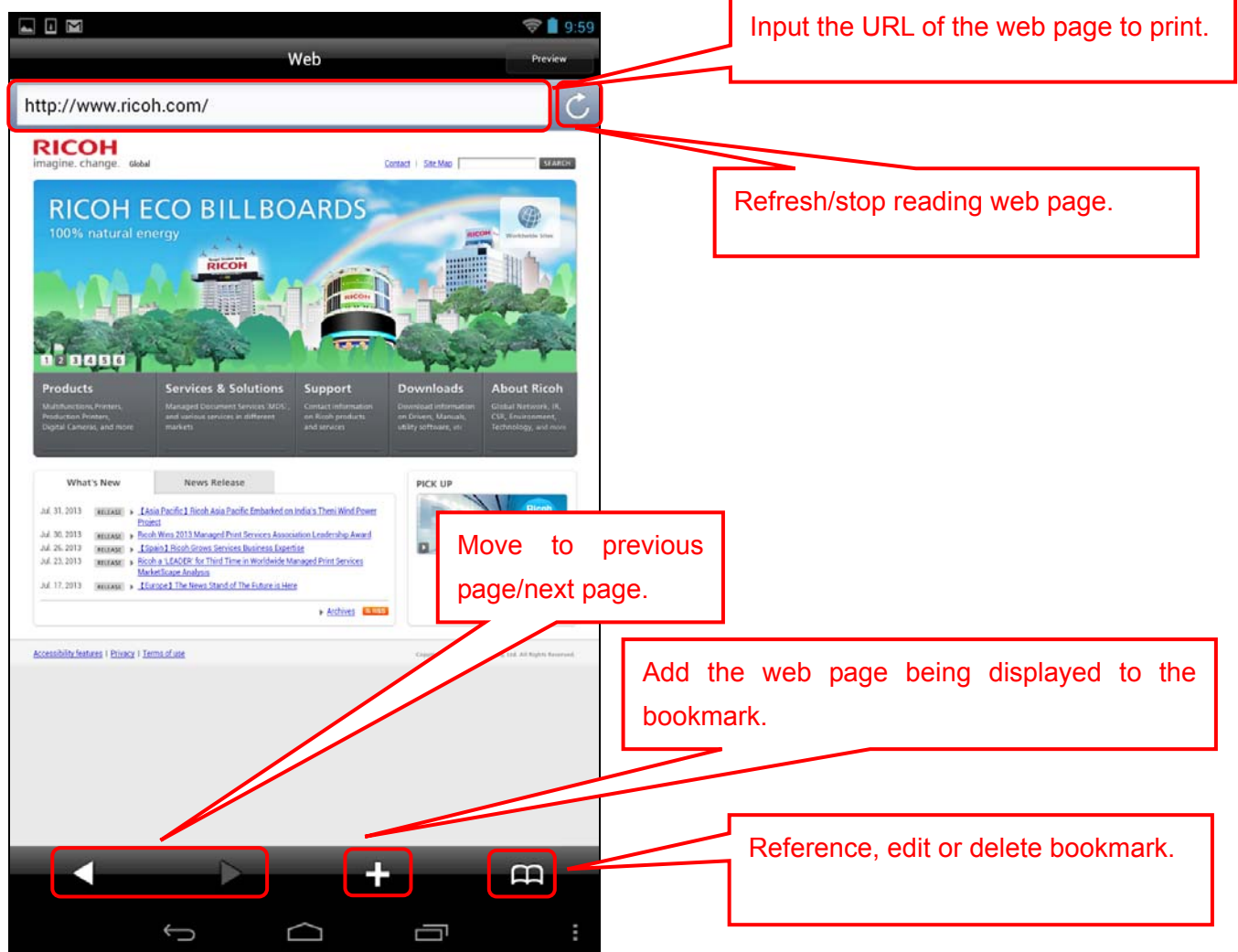

Print the web page displayed in the application.

1. Select [Web] menu.
2. Tap the URL input field.
3. Input the URL of the web page to print using the keyboard displayed.
4. Set print attributes as necessary.
5. Press [Print] button.

Note: Bookmarks are shared with the standard browser on Android devices.

Note: Depending on Android devices, it sometimes happens that bookmarks cannot be added in Smart Device Print. Please add the bookmarks by the standard browser on this occasion.

Note: Depending on the web page to display, web page may not be previewed or printed correctly.

(12) Printing photos, documents or Web page contents in other applications

Photos, documents or Web page contents in applications that allow them to be selected in other applications can be printed using Smart Device Print application.

The photos or documents that can be printed by Smart Device Print from other applications are in JPG or PDF format.

1. In other applications, select the photo, document or Web page contents you want to print in Smart Device Print, and with the photo, document or Web page contents displayed or selected, show < Select application > screen.
2. Select "Smart Device Print" from the list.
3. The application is switched to Smart Device Print, and the photo, document or Web page contents to print will be displayed in Smart Device Print.
4. Set print attributes as necessary, and press [Print] button to print.

Note: Since the procedure on how to show <Select application> screen varies with applications, please check the user manual of the application you are using for details.

(13) Displaying application information and user manual

Press the system key <Menu > on the menu screen, and About/Help screen will be displayed.

- About
Shows version information and contact information.

- Help

Shows the user manual on how to use this application, things to be paid attention to and more.

Legal Information

Apache License

Version 2.0, January 2004

<http://www.apache.org/licenses/>

TERMS AND CONDITIONS FOR USE, REPRODUCTION, AND DISTRIBUTION

1. Definitions.

"License" shall mean the terms and conditions for use, reproduction, and distribution as defined by Sections 1 through 9 of this document.

"Licensor" shall mean the copyright owner or entity authorized by the copyright owner that is granting the License.

"Legal Entity" shall mean the union of the acting entity and all other entities that control, are controlled by, or are under common control with that entity. For the purposes of this definition,

"control" means (i) the power, direct or indirect, to cause the direction or management of such entity, whether by contract or otherwise, or (ii) ownership of fifty percent (50%) or more of the outstanding shares, or (iii) beneficial ownership of such entity.

"You" (or "Your") shall mean an individual or Legal Entity exercising permissions granted by this License.

"Source" form shall mean the preferred form for making modifications, including but not limited to software source code, documentation source, and configuration files.

"Object" form shall mean any form resulting from mechanical transformation or translation of a Source form, including but not limited to compiled object code, generated documentation, and conversions to other media types.

"Work" shall mean the work of authorship, whether in Source or Object form, made available under the License, as indicated by a copyright notice that is included in or attached to the work (an example is provided in the Appendix below).

"Derivative Works" shall mean any work, whether in Source or Object form, that is based on (or derived from) the Work and for which the editorial revisions, annotations, elaborations, or other modifications represent, as a whole, an original work of authorship. For the purposes of this License, Derivative Works shall not include works that remain separable from, or merely link (or bind by name) to the interfaces of, the Work and Derivative Works thereof.

"Contribution" shall mean any work of authorship, including the original version of the Work and any modifications or additions to that Work or Derivative Works thereof, that is intentionally submitted to Licensor for inclusion in the Work by the copyright owner or by an individual or Legal Entity authorized to submit on behalf of the copyright owner. For the purposes of this definition, "submitted" means any form of electronic, verbal, or written communication sent to the Licensor or its representatives, including but not limited to communication on electronic mailing lists, source code control systems, and issue tracking systems that are managed by, or on behalf of, the Licensor for the purpose of discussing and improving the Work, but excluding communication that is conspicuously marked or otherwise designated in writing by the copyright owner as "Not a Contribution."

"Contributor" shall mean Licensor and any individual or Legal Entity on behalf of whom a Contribution has been received by Licensor and subsequently incorporated within the Work.

2. Grant of Copyright License. Subject to the terms and conditions of this License, each Contributor hereby grants to You a perpetual, worldwide, non-exclusive, no-charge, royalty-free, irrevocable copyright license to reproduce, prepare Derivative Works of, publicly display, publicly perform, sublicense, and distribute the

Work and such Derivative Works in Source or Object form.

3. Grant of Patent License. Subject to the terms and conditions of this License, each Contributor hereby grants to You a perpetual, worldwide, non-exclusive, no-charge, royalty-free, irrevocable (except as stated in this section) patent license to make, have made, use, offer to sell, sell, import, and otherwise transfer the Work, where such license applies only to those patent claims licensable by such Contributor that are necessarily infringed by their Contribution(s) alone or by combination of their Contribution(s) with the Work to which such Contribution(s) was submitted. If You institute patent litigation against any entity (including a cross-claim or counterclaim in a lawsuit) alleging that the Work or a Contribution incorporated within the Work constitutes direct or contributory patent infringement, then any patent licenses granted to You under this License for that Work shall terminate as of the date such litigation is filed.

4. Redistribution. You may reproduce and distribute copies of the Work or Derivative Works thereof in any medium, with or without modifications, and in Source or Object form, provided that You meet the following conditions:

(a) You must give any other recipients of the Work or Derivative Works a copy of this License; and

(b) You must cause any modified files to carry prominent notices stating that You changed the files; and

(c) You must retain, in the Source form of any Derivative Works that You distribute, all copyright, patent, trademark, and attribution notices from the Source form of the Work, excluding those notices that do not pertain to any part of the Derivative Works; and

(d) If the Work includes a "NOTICE" text file as part of its

distribution, then any Derivative Works that You distribute must include a readable copy of the attribution notices contained within such NOTICE file, excluding those notices that do not pertain to any part of the Derivative Works, in at least one of the following places: within a NOTICE text file distributed as part of the Derivative Works; within the Source form or documentation, if provided along with the Derivative Works; or, within a display generated by the Derivative Works, if and wherever such third-party notices normally appear. The contents of the NOTICE file are for informational purposes only and do not modify the License. You may add Your own attribution notices within Derivative Works that You distribute, alongside or as an addendum to the NOTICE text from the Work, provided that such additional attribution notices cannot be construed as modifying the License.

You may add Your own copyright statement to Your modifications and may provide additional or different license terms and conditions for use, reproduction, or distribution of Your modifications, or for any such Derivative Works as a whole, provided Your use, reproduction, and distribution of the Work otherwise complies with the conditions stated in this License.

5. Submission of Contributions. Unless You explicitly state otherwise, any Contribution intentionally submitted for inclusion in the Work by You to the Licensor shall be under the terms and conditions of this License, without any additional terms or conditions.

Notwithstanding the above, nothing herein shall supersede or modify the terms of any separate license agreement you may have executed with Licensor regarding such Contributions.

6. Trademarks. This License does not grant permission to use the trade names, trademarks, service marks, or product names of the Licensor, except as required for reasonable and customary use in describing the origin of the Work and reproducing the content of the NOTICE file.

7. Disclaimer of Warranty. Unless required by applicable law or agreed to in writing, Licensor provides the Work (and each Contributor provides its Contributions) on an "AS IS" BASIS, WITHOUT WARRANTIES OR CONDITIONS OF ANY KIND, either express or implied, including, without limitation, any warranties or conditions of TITLE, NON-INFRINGEMENT, MERCHANTABILITY, or FITNESS FOR A PARTICULAR PURPOSE. You are solely responsible for determining the appropriateness of using or redistributing the Work and assume any risks associated with Your exercise of permissions under this License.

8. Limitation of Liability. In no event and under no legal theory, whether in tort (including negligence), contract, or otherwise, unless required by applicable law (such as deliberate and grossly negligent acts) or agreed to in writing, shall any Contributor be liable to You for damages, including any direct, indirect, special, incidental, or consequential damages of any character arising as a result of this License or out of the use or inability to use the Work (including but not limited to damages for loss of goodwill, work stoppage, computer failure or malfunction, or any and all other commercial damages or losses), even if such Contributor has been advised of the possibility of such damages.

9. Accepting Warranty or Additional Liability. While redistributing the Work or Derivative Works thereof, You may choose to offer, and charge a fee for, acceptance of support, warranty, indemnity, or other liability obligations and/or rights consistent with this License. However, in accepting such obligations, You may act only on Your own behalf and on Your sole responsibility, not on behalf of any other Contributor, and only if You agree to indemnify, defend, and hold each Contributor harmless for any liability incurred by, or claims asserted against, such Contributor by reason of your accepting any such warranty or additional liability.

END OF TERMS AND CONDITIONS

APPENDIX: How to apply the Apache License to your work.

To apply the Apache License to your work, attach the following boilerplate notice, with the fields enclosed by brackets "[]" replaced with your own identifying information. (Don't include the brackets!) The text should be enclosed in the appropriate comment syntax for the file format. We also recommend that a file or class name and description of purpose be included on the same "printed page" as the copyright notice for easier identification within third-party archives.

Copyright 2012 [name of copyright owner]

Licensed under the Apache License, Version 2.0 (the "License");
you may not use this file except in compliance with the License.
You may obtain a copy of the License at

<http://www.apache.org/licenses/LICENSE-2.0>

Unless required by applicable law or agreed to in writing, software
distributed under the License is distributed on an "AS IS" BASIS,
WITHOUT WARRANTIES OR CONDITIONS OF ANY KIND, either express or implied.
See the License for the specific language governing permissions and
limitations under the License.

libjpeg-6b

<http://www.ijg.org/>

There are some items seeking the notification to customer from the author of the OSS, besides the common descriptions.

Therefore, the full text reads as follows. In addition, ansi2knr.c, configure, config.guess, config.sub, ltconfig, ltmain.sh, install-sh in the following referred program are not included in this product.

LEGAL ISSUES

=====

In plain English:

1. We don't promise that this software works. (But if you find any bugs, please let us know!)
2. You can use this software for whatever you want. You don't have to pay us.
3. You may not pretend that you wrote this software. If you use it in a

program, you must acknowledge somewhere in your documentation that
you've used the IJG code.

In legalese:

The authors make NO WARRANTY or representation, either express or implied,
with respect to this software, its quality, accuracy, merchantability, or
fitness for a particular purpose. This software is provided "AS IS", and you,
its user, assume the entire risk as to its quality and accuracy.

This software is copyright (C) 1991-1998, Thomas G. Lane.
All Rights Reserved except as specified below.

Permission is hereby granted to use, copy, modify, and distribute this
software (or portions thereof) for any purpose, without fee, subject to these
conditions:

- (1) If any part of the source code for this software is distributed, then this
README file must be included, with this copyright and no-warranty notice
unaltered; and any additions, deletions, or changes to the original files
must be clearly indicated in accompanying documentation.
- (2) If only executable code is distributed, then the accompanying
documentation must state that "this software is based in part on the work of
the Independent JPEG Group".
- (3) Permission for use of this software is granted only if the user accepts
full responsibility for any undesirable consequences; the authors accept
NO LIABILITY for damages of any kind.

These conditions apply to any software derived from or based on the IJG code,
not just to the unmodified library. If you use our work, you ought to
acknowledge us.

Permission is NOT granted for the use of any IJG author's name or company name
in advertising or publicity relating to this software or products derived from
it. This software may be referred to only as "the Independent JPEG Group's
software".

We specifically permit and encourage the use of this software as the basis of commercial products, provided that all warranty or liability claims are assumed by the product vendor.

ansi2knr.c is included in this distribution by permission of L. Peter Deutsch, sole proprietor of its copyright holder, Aladdin Enterprises of Menlo Park, CA. ansi2knr.c is NOT covered by the above copyright and conditions, but instead by the usual distribution terms of the Free Software Foundation; principally, that you must include source code if you redistribute it. (See the file ansi2knr.c for full details.) However, since ansi2knr.c is not needed as part of any program generated from the IJG code, this does not limit you more than the foregoing paragraphs do.

The Unix configuration script "configure" was produced with GNU Autoconf. It is copyright by the Free Software Foundation but is freely distributable. The same holds for its supporting scripts (config.guess, config.sub, ltconfig, ltmain.sh). Another support script, install-sh, is copyright by M.I.T. but is also freely distributable.

It appears that the arithmetic coding option of the JPEG spec is covered by patents owned by IBM, AT&T, and Mitsubishi. Hence arithmetic coding cannot legally be used without obtaining one or more licenses. For this reason, support for arithmetic coding has been removed from the free JPEG software. (Since arithmetic coding provides only a marginal gain over the unpatented Huffman mode, it is unlikely that very many implementations will support it.) So far as we are aware, there are no patent restrictions on the remaining code.

The IJG distribution formerly included code to read and write GIF files. To avoid entanglement with the Unisys LZW patent, GIF reading support has been removed altogether, and the GIF writer has been simplified to produce "uncompressed GIFs". This technique does not use the LZW algorithm; the resulting GIF files are larger than usual, but are readable by all standard GIF decoders.

We are required to state that

"The Graphics Interchange Format(c) is the Copyright property of
CompuServe Incorporated. GIF(sm) is a Service Mark property of
CompuServe Incorporated."

OpenSSL License

LICENSE ISSUES

=====

The OpenSSL toolkit stays under a dual license, i.e. both the conditions of
the OpenSSL License and the original SSLeay license apply to the toolkit.
See below for the actual license texts. Actually both licenses are BSD-style
Open Source licenses. In case of any license issues related to OpenSSL
please contact openssl-core@openssl.org.

OpenSSL License

/* =====

* Copyright (c) 1998-2011 The OpenSSL Project. All rights reserved.

*

* Redistribution and use in source and binary forms, with or without

* modification, are permitted provided that the following conditions

* are met:

*

* 1. Redistributions of source code must retain the above copyright

* notice, this list of conditions and the following disclaimer.

*

* 2. Redistributions in binary form must reproduce the above copyright

* notice, this list of conditions and the following disclaimer in

* the documentation and/or other materials provided with the

* distribution.

*

* 3. All advertising materials mentioning features or use of this

* software must display the following acknowledgment:

* "This product includes software developed by the OpenSSL Project

* for use in the OpenSSL Toolkit. (<http://www.openssl.org/>)"

*

* 4. The names "OpenSSL Toolkit" and "OpenSSL Project" must not be used to

* endorse or promote products derived from this software without

* prior written permission. For written permission, please contact

* openssl-core@openssl.org.

*

* 5. Products derived from this software may not be called "OpenSSL"

* nor may "OpenSSL" appear in their names without prior written

* permission of the OpenSSL Project.

*

* 6. Redistributions of any form whatsoever must retain the following

* acknowledgment:

* "This product includes software developed by the OpenSSL Project

* for use in the OpenSSL Toolkit (<http://www.openssl.org/>)"

*

* THIS SOFTWARE IS PROVIDED BY THE OpenSSL PROJECT ``AS IS" AND ANY

* EXPRESSED OR IMPLIED WARRANTIES, INCLUDING, BUT NOT LIMITED TO, THE

* IMPLIED WARRANTIES OF MERCHANTABILITY AND FITNESS FOR A PARTICULAR

* PURPOSE ARE DISCLAIMED. IN NO EVENT SHALL THE OpenSSL PROJECT OR

* ITS CONTRIBUTORS BE LIABLE FOR ANY DIRECT, INDIRECT, INCIDENTAL,

* SPECIAL, EXEMPLARY, OR CONSEQUENTIAL DAMAGES (INCLUDING, BUT

* NOT LIMITED TO, PROCUREMENT OF SUBSTITUTE GOODS OR SERVICES;

* LOSS OF USE, DATA, OR PROFITS; OR BUSINESS INTERRUPTION)

* HOWEVER CAUSED AND ON ANY THEORY OF LIABILITY, WHETHER IN CONTRACT,

* STRICT LIABILITY, OR TORT (INCLUDING NEGLIGENCE OR OTHERWISE)

* ARISING IN ANY WAY OUT OF THE USE OF THIS SOFTWARE, EVEN IF ADVISED

* OF THE POSSIBILITY OF SUCH DAMAGE.

* =====

*

* This product includes cryptographic software written by Eric Young

* (ey@cryptsoft.com). This product includes software written by Tim

* Hudson (tjh@cryptsoft.com).

*

*/

Original SSLeay License

/* Copyright (C) 1995-1998 Eric Young (eay@cryptsoft.com)

* All rights reserved.

*

* This package is an SSL implementation written

* by Eric Young (eay@cryptsoft.com).

* The implementation was written so as to conform with Netscapes SSL.

*

* This library is free for commercial and non-commercial use as long as

* the following conditions are aheared to. The following conditions

* apply to all code found in this distribution, be it the RC4, RSA,

* lhash, DES, etc., code; not just the SSL code. The SSL documentation

* included with this distribution is covered by the same copyright terms

* except that the holder is Tim Hudson (tjh@cryptsoft.com).

*

* Copyright remains Eric Young's, and as such any Copyright notices in

* the code are not to be removed.

* If this package is used in a product, Eric Young should be given attribution

* as the author of the parts of the library used.

* This can be in the form of a textual message at program startup or

* in documentation (online or textual) provided with the package.

*

* Redistribution and use in source and binary forms, with or without

* modification, are permitted provided that the following conditions

* are met:

* 1. Redistributions of source code must retain the copyright

* notice, this list of conditions and the following disclaimer.

* 2. Redistributions in binary form must reproduce the above copyright

* notice, this list of conditions and the following disclaimer in the

* documentation and/or other materials provided with the distribution.

* 3. All advertising materials mentioning features or use of this software

* must display the following acknowledgement:

* "This product includes cryptographic software written by

* Eric Young (eay@cryptsoft.com)"

* The word 'cryptographic' can be left out if the rouines from the library

* being used are not cryptographic related :-).

* 4. If you include any Windows specific code (or a derivative thereof) from

* the apps directory (application code) you must include an acknowledgement:

* "This product includes software written by Tim Hudson (tjh@cryptsoft.com)"

*

* THIS SOFTWARE IS PROVIDED BY ERIC YOUNG ``AS IS" AND

* ANY EXPRESS OR IMPLIED WARRANTIES, INCLUDING, BUT NOT LIMITED TO, THE

* IMPLIED WARRANTIES OF MERCHANTABILITY AND FITNESS FOR A PARTICULAR PURPOSE

* ARE DISCLAIMED. IN NO EVENT SHALL THE AUTHOR OR CONTRIBUTORS BE LIABLE

* FOR ANY DIRECT, INDIRECT, INCIDENTAL, SPECIAL, EXEMPLARY, OR CONSEQUENTIAL

* DAMAGES (INCLUDING, BUT NOT LIMITED TO, PROCUREMENT OF SUBSTITUTE GOODS

* OR SERVICES; LOSS OF USE, DATA, OR PROFITS; OR BUSINESS INTERRUPTION)

* HOWEVER CAUSED AND ON ANY THEORY OF LIABILITY, WHETHER IN CONTRACT, STRICT

* LIABILITY, OR TORT (INCLUDING NEGLIGENCE OR OTHERWISE) ARISING IN ANY WAY

* OUT OF THE USE OF THIS SOFTWARE, EVEN IF ADVISED OF THE POSSIBILITY OF

* SUCH DAMAGE.

*

* The licence and distribution terms for any publically available version or

* derivative of this code cannot be changed. i.e. this code cannot simply be

* copied and put under another distribution licence

* [including the GNU Public Licence.]

*/

Zlib

/* zlib.h -- interface of the 'zlib' general purpose compression library

version 1.2.8, April 28th, 2013

Copyright (C) 1995-2013 Jean-loup Gailly and Mark Adler

This software is provided 'as-is', without any express or implied

warranty. In no event will the authors be held liable for any damages

arising from the use of this software.

Permission is granted to anyone to use this software for any purpose,

including commercial applications, and to alter it and redistribute it

freely, subject to the following restrictions:

1. The origin of this software must not be misrepresented; you must not claim that you wrote the original software. If you use this software in a product, an acknowledgment in the product documentation would be appreciated but is not required.
2. Altered source versions must be plainly marked as such, and must not be misrepresented as being the original software.
3. This notice may not be removed or altered from any source distribution.

Jean-loup Gailly

Mark Adler

jloup@gzip.org

madler@alumni.caltech.edu

*/

