

# Chapter 4

---

## ERASING

---

Erasing Files .....	114
Erase Single Image .....	114
Erase All Images .....	115
Erase Selected Images .....	116

# Erasing Files

## Important Note

- Files cannot be restored once they are erased. Before starting to erase a file, make sure that you want to erase it.

This section explains how to erase recorded files. There are three ways to erase files:

- 1) ERASE SINGLE IMAGE for erasing one selected file at a time.
- 2) ERASE ALL IMAGES for erasing all files at once.
- 3) ERASE SELECTED IMAGES for erasing multiple selected files.

## Note



- Files on a write-protected SmartMedia memory card cannot be erased unless the write protect pad is removed from the card. See "Protecting Against Accidental Writing" (p.26).
- Only files that have been taken with this camera can be erased.
- Protected files, which are identified by the  mark, cannot be erased until they are unprotected. See "Protecting a File" (p.106).
- Erasing time may vary depending on the capacity of the SmartMedia memory card and the type of file.

## Erase Single Image

The selected file is erased.

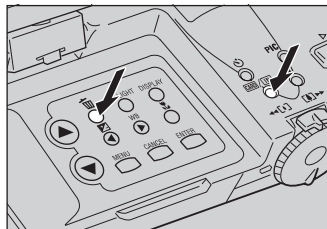
- 1 Set the mode dial to [  ] and press the **CARD/IN** button to select the erase source.



- 2 Press the  button.
- 3 Press the  or  button to select [ERASE SINGLE IMAGE] and press the ENTER button.

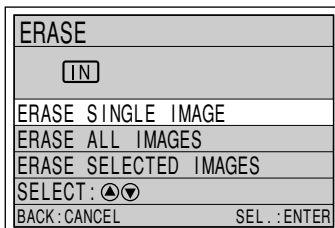

- 4** Press the  or  button to select the file to be erased and press the shutter release button.

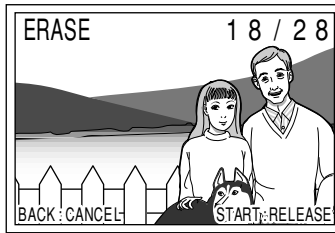

The selected file will be erased. To erase more files, repeat step 4.

- 5** Press the **CANCEL** button.

The display will return to the erase menu.

## Erasing All Images

All recorded files in the folder are erased.

- 1** Set the mode dial to [  ] and press the **CARD/IN** button to select the erase source.

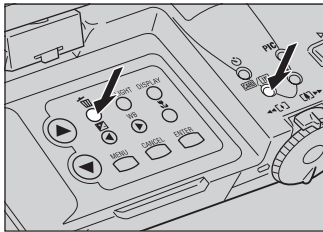

- 2** Press the  button.

- 3** Press the  or  button to select [ERASE ALL IMAGES] and press the **ENTER** button.

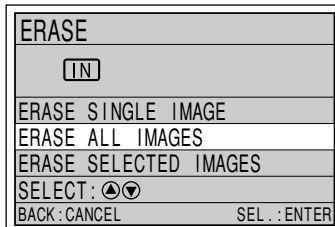

### Note

- When a file is erased, the subsequent file numbers are reassigned.

## 4 Press the shutter release button.

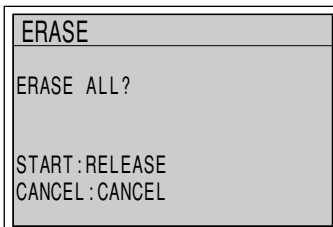

All the files will be erased and the display will return to the erase menu.

## Erase Selected Images

Multiple selected files are erased.

### 1 Set the mode dial to [ ] and press the / button to select the erase source.

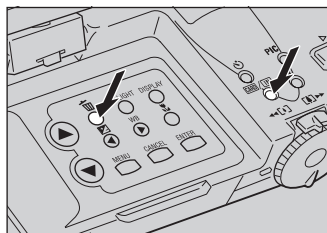

### 2 Press the button.

### 3 Press the or button to select [ERASE SELECTED IMAGES] and press the ENTER button.

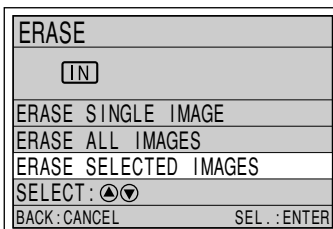

#### Note

- To cancel selection, press the ENTER button again and the  mark will disappear.

### 4 Press the or button and the or button to select a file to be erased and press the ENTER button.



The selected file will be identified by the  mark.  
To select more files, repeat step 4.

## 5 Press the shutter release button.

The selected files will be erased and the display will return to the erase menu.

